

# General features

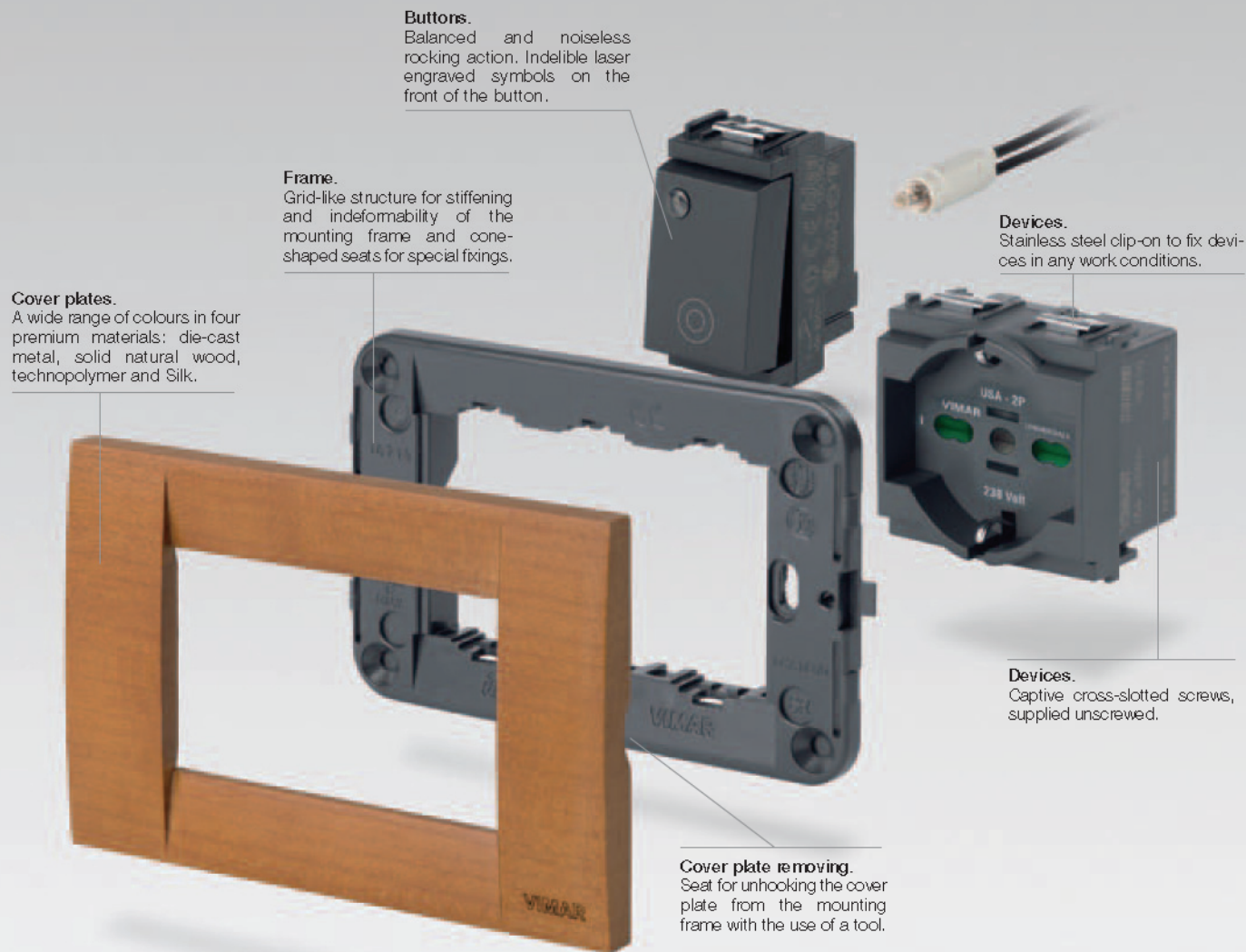

## Reduced module

The most important functions are realized also with a reduced module to have 2 appliances or 1 appliance sized 2 modules in  $\varnothing$  60 mm or in square mounting boxes.

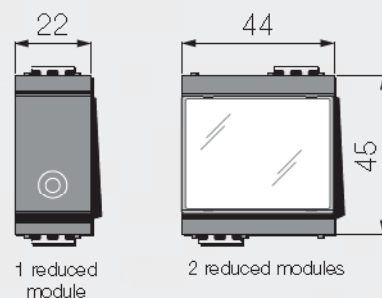

## Device fixing and removing

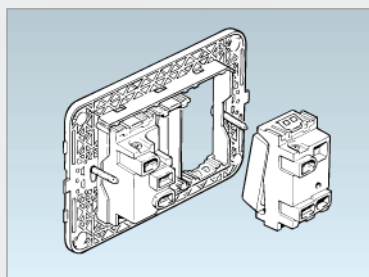

Fixing from rear of the mounting frame.

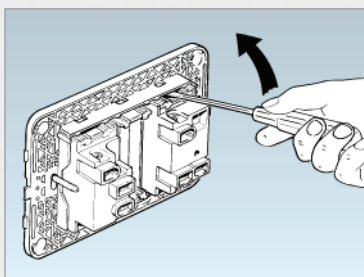

Removal with use of a tool, possible also from the front of the device.

### Degree of protection of the assembly

The following IP degree of protection is considered assigned to the assembly formed by equipment, mounting frame and cover plate, flush mounted on vertical position (Standard IEC 60364-7-701):

- IP41 with closed front equipments (i.e. switches, bells, buzzers, etc.)
- IPX1 with open front equipments (i.e. socket outlets, etc.)

The assembly can therefore be installed within zone 3 in bathrooms and shower baths.